



**SUBSCRIPTION
ADVANTAGE PACKS:
MORE POWER TO YOU**

Autodesk® Subscription customers already enjoy access to exclusive tools, training, and web support through Subscription Center. But now there's even more.

Autodesk® Subscription Advantage Packs are now available for 2010 Autodesk software. They provide Subscription customers with early access to the latest product enhancements—boosting productivity and offering a significant competitive edge.

With new features and specialized functionality, tools, and content that are fully compatible with the latest software release, Subscription Advantage Packs help you benefit from the latest capabilities. And, they can be downloaded from Subscription Center—or right from inside most 2010 software.

To download a Subscription Advantage Pack, sign in to Subscription Center today at:
www.autodesk.com/subscriptionlogin.

Subscription Advantage Pack for Autodesk® Revit® MEP 2010

The Subscription Advantage Pack for Autodesk Revit MEP 2010 extends the capabilities of Revit MEP 2010 software. Productivity-enhancing functionality and features better support coordination and documentation, while improved tools help you work more efficiently within the software.

In addition, new applications that complement Revit MEP 2010 workflows will help you:

- Validate the accuracy of building information models created in Revit MEP 2010 against pre-determined standards.
- Import and export data between a Revit project and an external database, and then more easily maintain the relationships of linked data.
- Facilitate the use of building information modeling (BIM) for building renovation projects by creating 3D models from 2D digital photographs.

FEATURES AND BENEFITS

- 1. Subscription Release Pack for Autodesk Revit MEP 2010**—Improve productivity with the Subscription Release Pack for Autodesk Revit MEP 2010:
 - Gain exclusive access to new functionality and tools, such as the ability to show temporary dimensions when laying out branches and pipe runs.
 - Work more efficiently with greater control of keyboard shortcuts and improved access to some frequently used commands.
 - Access the latest updates available for Revit MEP 2010 (Update 2).

- 2. Revit Extensions for Autodesk Revit MEP 2010**—Revit® Extensions extend the capabilities of Revit MEP 2010 in key areas, including coordination and documentation. This pack contains updates to previously released Revit Extensions.

- 3. Autodesk Revit Model Review**—Automate the process of reviewing and auditing BIM projects in Revit MEP 2010 with the Autodesk® Revit® Model Review plug-in:
 - Check the accuracy and consistency of a model against standards set by your firm, your clients, or industry best practices.
 - Correct inconsistencies with a single click or with instructions provided when manual fixes are required.

- 4. Autodesk Revit DB Link**—Import and export data between a Revit MEP 2010 project and an external database, and then more easily maintain relationships of linked data with Autodesk® Revit® DB Link.
 - A grid view of the data enables you to make any final edits before import.
 - Databases can be updated following internal or external changes.
 - The grid control enables you to create Revit shared parameters to add new fields to related tables in the database.
 - Changes to new fields within the database automatically update Revit shared parameters upon future imports.

- 5. Autodesk ImageModeler 2009**—Use 2D digital photographs to more quickly and cost-effectively create, edit, and texture 3D models for building renovation projects and energy-efficiency analysis. Bridging the 2D and 3D worlds via DWG™, Autodesk® ImageModeler™ 2009 software helps enable you to:
 - Capture building design elements
 - Take measurements
 - Create 3D models based on the form of existing buildings

By leveraging models developed directly from the physical environment, ImageModeler 2009 helps mechanical, electrical, and plumbing (MEP) engineers better integrate improvements or renovations in BIM projects.

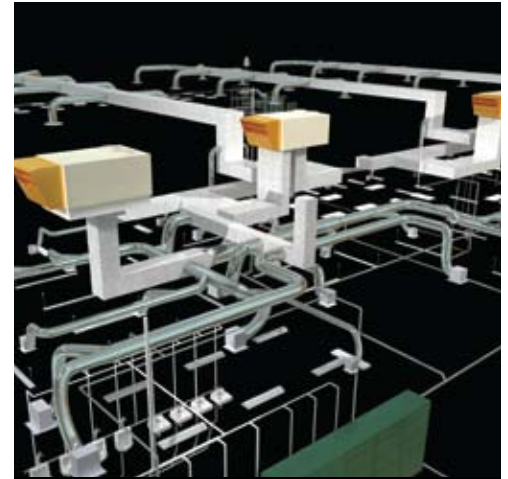

Image courtesy of Design West Engineering

PRODUCT COMPATIBILITY

The Subscription Advantage Pack for Autodesk Revit MEP 2010 works with:

- Autodesk® Revit® MEP
- AutoCAD® Revit® MEP Suite
- Autodesk® Education Master Suite 2010
- Autodesk® Education Suite for Architecture & Engineering 2010
- Autodesk® Education Suite for Civil & Structural Engineering 2010
- Autodesk® Design Academy 2010

LANGUAGES AVAILABLE

The Subscription Advantage Pack for Autodesk Revit MEP 2010 is available in:

- English
- Chinese (Simplified)
- French
- Japanese
- Russian

Subscription Advantage Packs can be downloaded by signing in to Subscription Center. For more information visit www.autodesk.com/advantagepacks.



NOTE: Autodesk ImageModeler and Autodesk Model Review are available in English only.

Cover rendering courtesy of Natalie Chusa.

Autodesk, AutoCAD, DWG, ImageModeler, and Revit are registered trademarks or trademarks of Autodesk, Inc., and/or its subsidiaries and/or affiliates in the USA and/or other countries. All other brand names, product names, or trademarks belong to their respective holders. Autodesk reserves the right to alter product offerings and specifications at any time without notice, and is not responsible for typographical or graphical errors that may appear in this document. © 2009 Autodesk, Inc. All rights reserved. 09-AD-1012RevA

Autodesk® Subscription